

环保物料

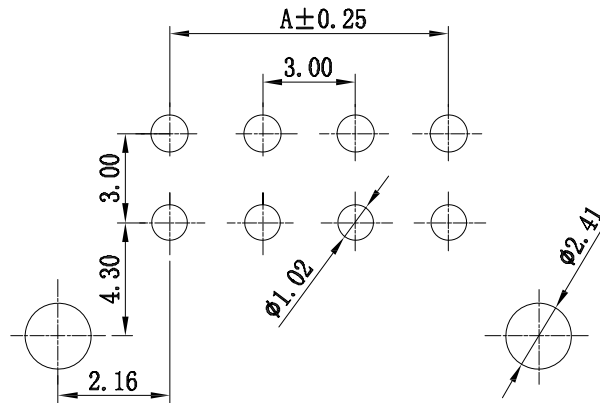

P. C. B LAYOUT

Specifications:
 Contact resistance: ≤20mΩ
 Insulation resistance: ≥1000MΩ
 Rated voltage: 250V AC DC
 Rated current: 5.0A AC DC
 Withstand Voltage: 1000V AC/minute
 Temperature Range: -25°C ~ +85°C

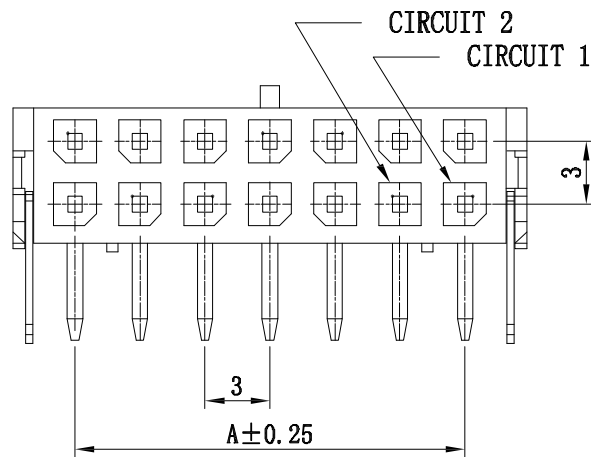
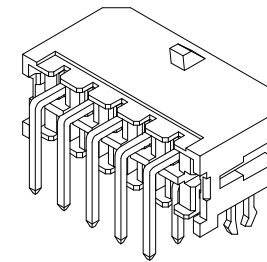
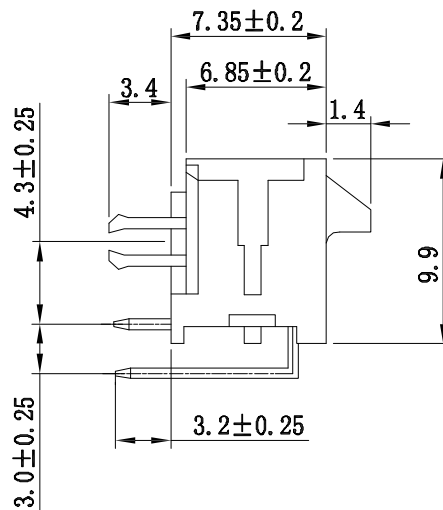
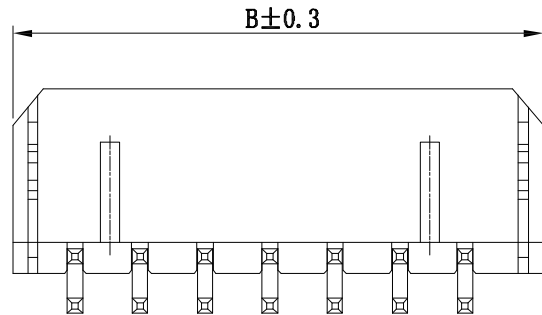

Poles	DIM A	DIM B
2x1		6.65
2x2	3.00	9.65
2x3	6.00	12.65
2x4	9.00	15.65
2x5	12.00	18.65
2x6	15.00	21.65
2x7	18.00	24.65
2x8	21.00	27.65
2x9	24.00	30.65
2x10	27.00	33.65
2x11	30.00	36.65
2x12	33.00	39.65

序号	图号	名称	材料	数量	附注
3		Press-fit	Brass Tin	2	
2		Contact	Brass Tin	N	
1		Housing	LCP (UL94V-0)	1	Black

GENERAL TOLERANCES		SCALE:	NAME	DATE	康导新能源 网址: www.dgonns.com 电话: 0769-85337633 邮箱: 2850176986@qq.com 传真: 0769-85392827	PART. NO: 23002AWRC	
LINEAR	ANGLES	1:1	APPROVED	黎腾			2017.06.16
0.00±0.25	X° REF±6°	DESIGNER	肖坤权	2017.06.16			DWG. NO:
0.000±0.15	X° X'±2°	DRAWN	旷淇	2017.06.16			
REV.	REVISION RECORD	DATE	UNIT: MM	SIZE: A4	TITLE: 3.00mmPITCH 90° WAFER DIP TYPE	REV: A0 SHEET: 1/1	