

环保物料

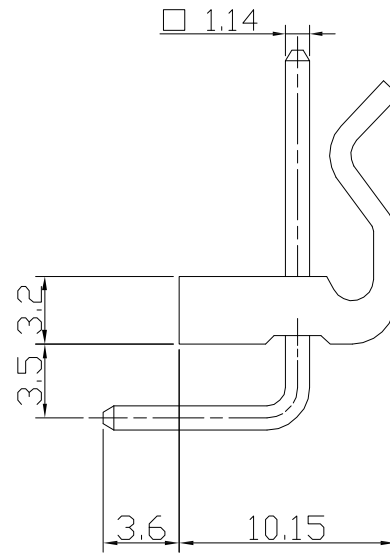

Specifications:

Contact resistance: $\leq 20m\Omega$
 Insulation resistance: $\geq 1000M\Omega$
 Rated voltage: 250V AC DC
 Rated current: 7.0A AC DC
 Withstand Voltage: 1500V AC/minute
 Temperature Range: $-25^{\circ}C \sim +85^{\circ}C$

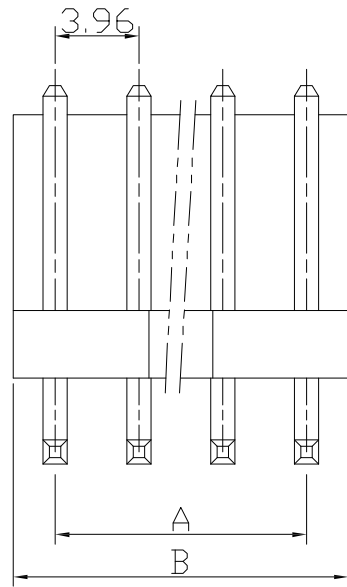
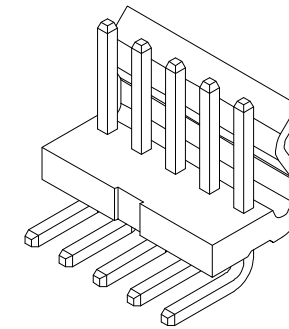

Poles	Dimensions mm	
	A	B
2	3.96	7.92
3	7.92	11.88
4	11.88	15.84
5	15.84	19.80
6	19.80	23.76
7	23.76	27.72
8	27.72	31.68
9	31.68	35.64
10	35.64	39.60
11	39.60	43.56
12	43.56	47.52
13	47.52	51.48
14	51.48	55.44
15	55.44	59.40
16	59.40	63.36

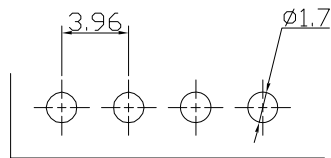

P. C. B LAYOUT

2		Wafer 针	Brass Tin 黄铜镀锡	N	
1		Housing 基座	PA66 (UL94V-2)	1	Transparent 透明白色
序号	图号	名称	材料	数量	附注

		GENERAL TOLERANCES		SCALE:	NAME	DATE
		LINEAR	ANGLES	1:1		
		0.0 ± 0.35	X° REF ± 6°	APPROVED	黎腾	2017.06.16
A0	新图面发行	0.00 ± 0.25	X° ± 3°	DESIGNER	肖坤权	2017.06.16
REV.	REVISION RECORD	0.000 ± 0.15	X° X' ± 2°	DRAWN	旷淇	2017.06.16



PART. NO:		23961AWG	
DWG. NO:			
REV:	A0	SHEET:	1/1