

环保物料

Pin数	尺寸A	尺寸B
2x1	-	2.50
2x2	2.50	5.00
2x3	5.00	7.50
2x4	7.50	10.00
2x5	10.00	12.50
2x6	12.50	15.00
2x7	15.00	17.50
2x8	17.50	20.00
2x9	20.00	22.50
2x10	22.50	25.00
2x11	25.00	27.50
2x12	27.50	30.00
2x13	30.00	32.50
2x14	32.50	35.00
2x15	35.00	37.50
2x16	37.50	40.00
2x17	40.00	42.50
2x18	42.50	45.00
2x19	45.00	47.50
2x20	47.50	50.00
2x21	50.00	52.50
2x22	52.50	55.00
2x23	55.00	57.50
2x24	57.50	60.00
2x25	60.00	62.50
2x26	62.50	65.00
2x27	65.00	67.50
2x28	67.50	70.00
2x29	70.00	72.50
2x30	72.50	75.00
2x31	75.00	77.50
2x32	77.50	80.00
2x33	80.00	82.50
2x34	82.50	85.00
2x35	85.00	87.50
2x36	87.50	90.00
2x37	90.00	92.50
2x38	92.50	95.00
2x39	95.00	97.50
2x40	97.50	100.00

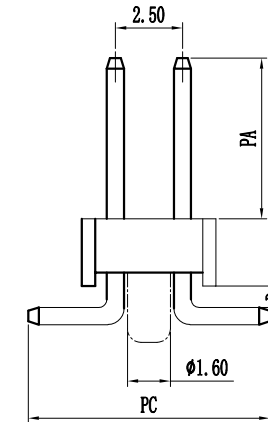

PCB LAYOUT

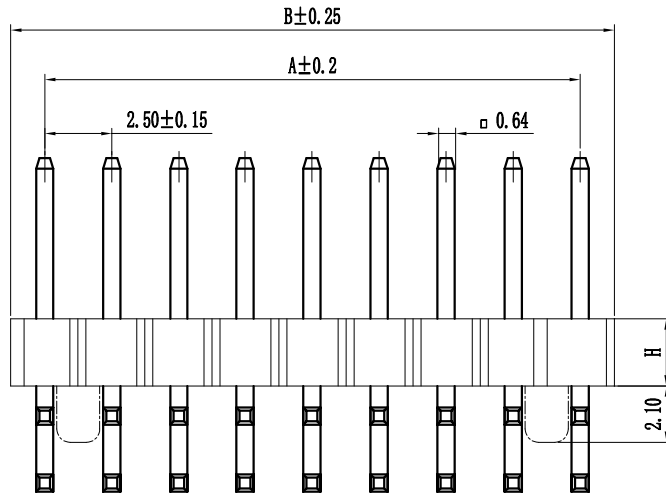
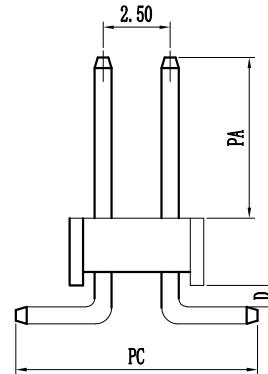
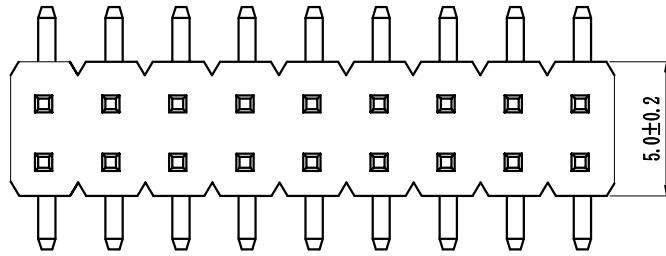
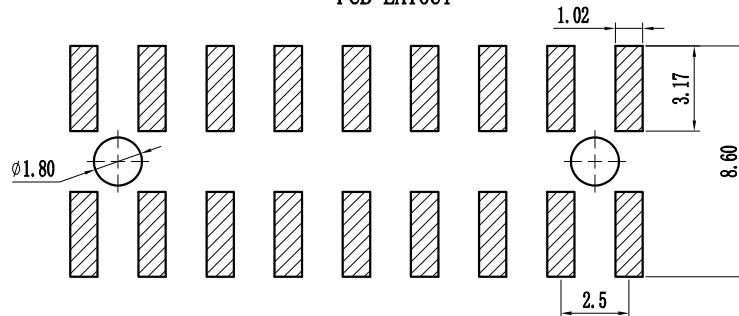

Specification:
 Current Rating : 3.0AMP
 Temperature Range : -40℃to+105℃
 Contact Resistance : 20mΩ Max
 Insulation Resistance : 1000MΩ Min
 Withstanding Voltage : AC 500V
 Material:
 Insulator : Polyester (UL94V-0)
 Standard:PA6T/LCP
 Contact: Brass
 Plating : Au or Sn Over 50u" Ni

Height
H=1.5mm、3.0mm、3.3mm

P 2X 9S-XXX X X-XX-X-XXX
 ① ② ③ ④ ⑤ ⑥ ⑦ ⑧ ⑨

① Series No: P=Pin Header F=Female Header B=Box Header E=Injector Header	② Pitch: 08=0.80 10=1.00 12=1.27 20=2.00 2X=2.50 39=3.96 50=5.08	③ Tail&Mounting Style: 90=Right Angle DIP Type 9S=Straight SMT Type 0D=Straight DIP Type 0S=Horizontal SMT Type	④ No. of Pins: Single Row 101=1*1Pin 102=1*2Pin 140=1*40pin	⑤ Double Row 201=2*1Pin 202=2*2Pin 240=2*40pin	⑥ Insulator Color: A:Black B:Brown C:Red D:Orange E:Yellow F:Green G:Blue H:Violet J:Gray K:White P:Light Blue
⑦ Material Type: A-PBT B-PA46 C-PA6T D-PA9T E-LCP	⑧ Plating Type: 0*-Sn-Au 1*-Ni 2*-Sn 3*-Matte-Tin 5*-Au 0A-Sn-Au 1u" 0F-Sr-Au 10u" 5A-Au 1u" 0B-Sn-Au 2u" 0G-Sn-Au 15u" 6B-Au 2u" 0C-Sn-Au 3u" 0H-Sn-Au 30u" 5C-Au 3u" 0D-Sn-Au 4u" 0I-Sn-Au 40u" ! 0E-Sn-Au 5u" 0J-Sn-Au 50u" 5J-Au 50u"	⑨ RoHS Request: 0:No Request 1:RoHS 2:HF (Halogen Free)	⑩ Customer Code		

REV.	REVISION RECORD	DATE	UNIT: MM	GENERAL TOLERANCES		SCALE: 1:1	NAME	DATE
				LINEAR	ANGLES			
				0.00±0.15	X° REF±6°	APPROVED	黎腾	2017.06.16
				0.00±0.08	X° X'±2°	DESIGNER	肖坤权	2017.06.16
						DRAWN	旷淇	2017.06.16

康导新能源
 网址: www.dgconne.com 电话: 0788-85337833
 邮箱: 2850175988@qq.com 传真: 0788-85392827

TITLE:
Pitch2.50mm Pin Header, Single Plastic,
Dual Row, SMT Type

PART. NO: KDPH-0080
DWG. NO: ENDE0080
REV: AO SHEET: 1/1